

Broil King®



Broil King®

REGAL 690
9972-83NZ

Onward
SINCE 1906
MANUFACTURING COMPANY
585 KUMPF DRIVE LIMITED
WATERLOO, ONTARIO, CANADA
N2V 1K3

20084-E76NZ REV A 02/22

HARDWARE INCLUDED / MATERIAL INCLUS / EQUIPOS INCLUIDO

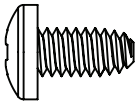
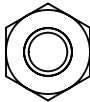
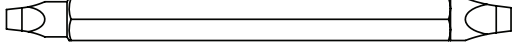
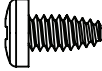
Y-12865		(28)	Y-11793		(4)
	 #3 ROBERTSON #2 ROBERTSON		Y-29304		(2)

TOOLS REQUIRED / OUTILS NECESSAIRES / HERRAMIENTAS NECESARIAS

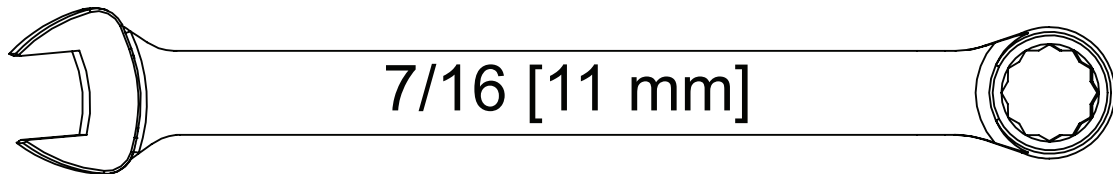

1

(24)

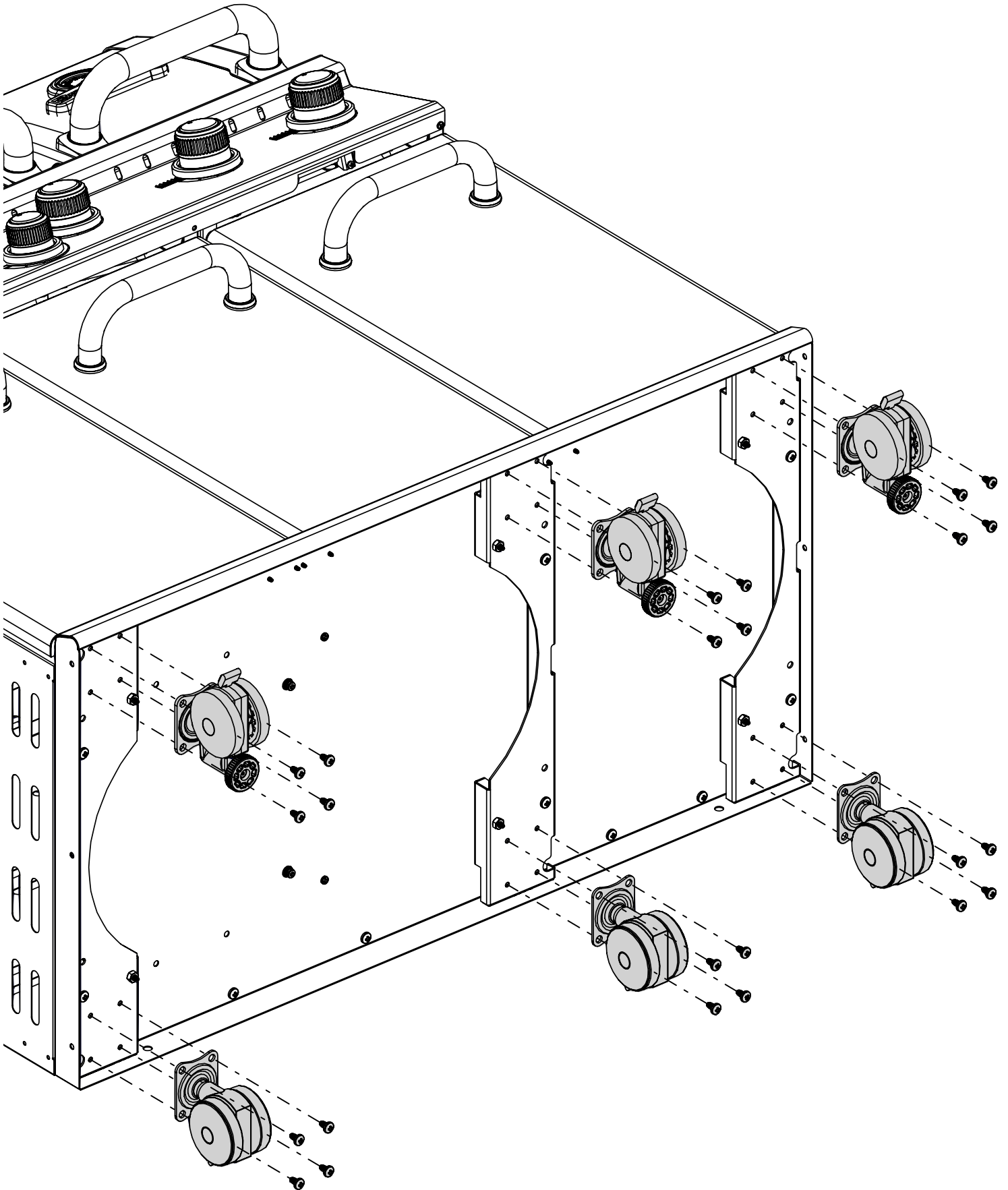
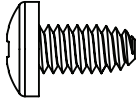

2

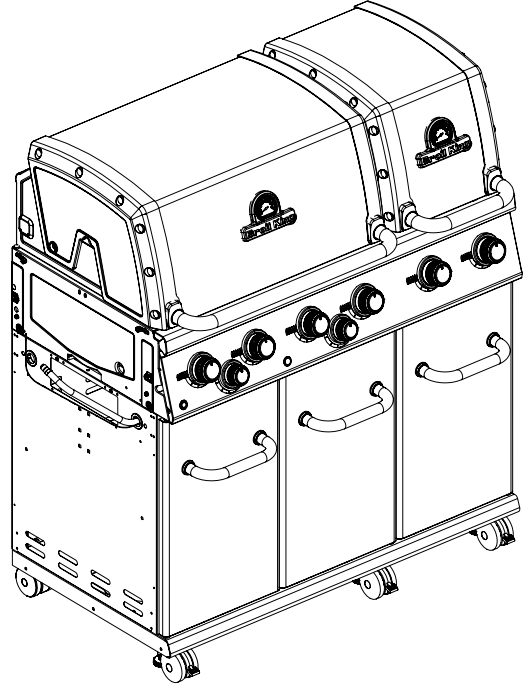
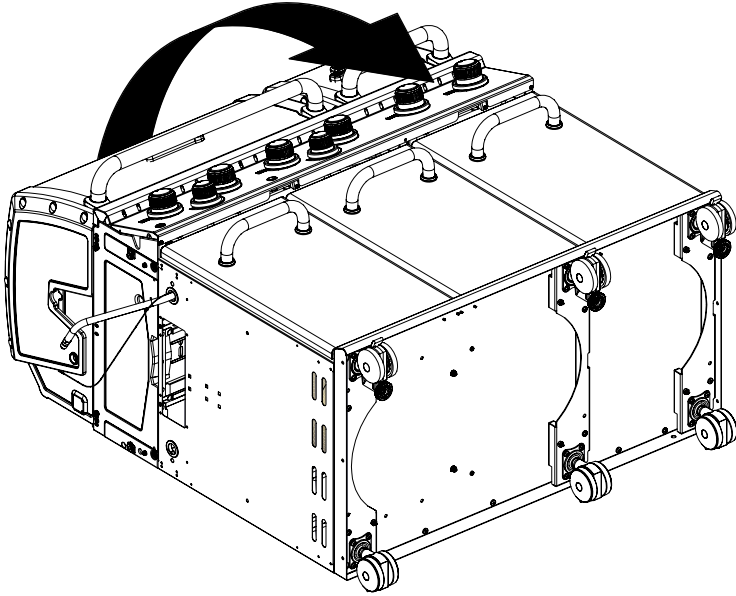
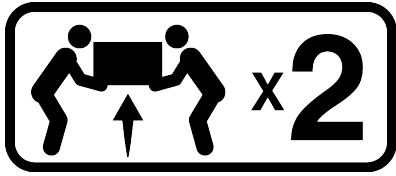

3

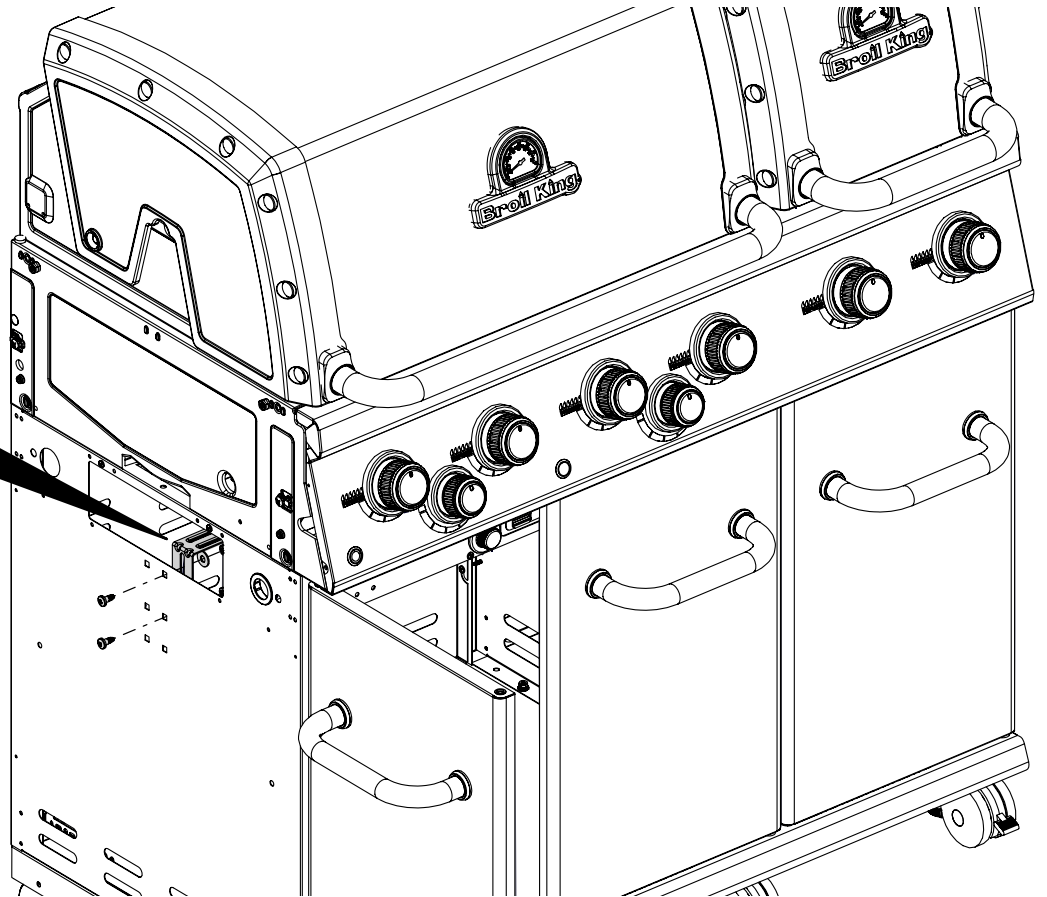
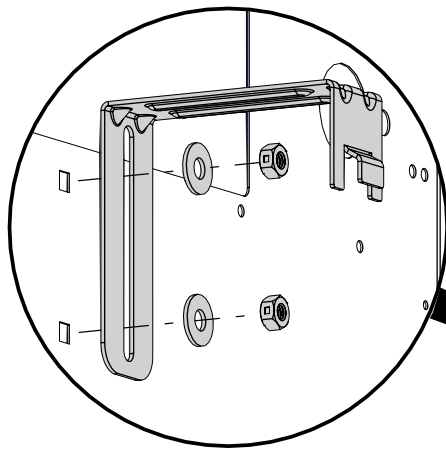
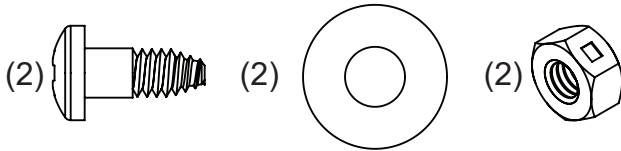

4

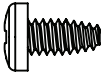
(2) 

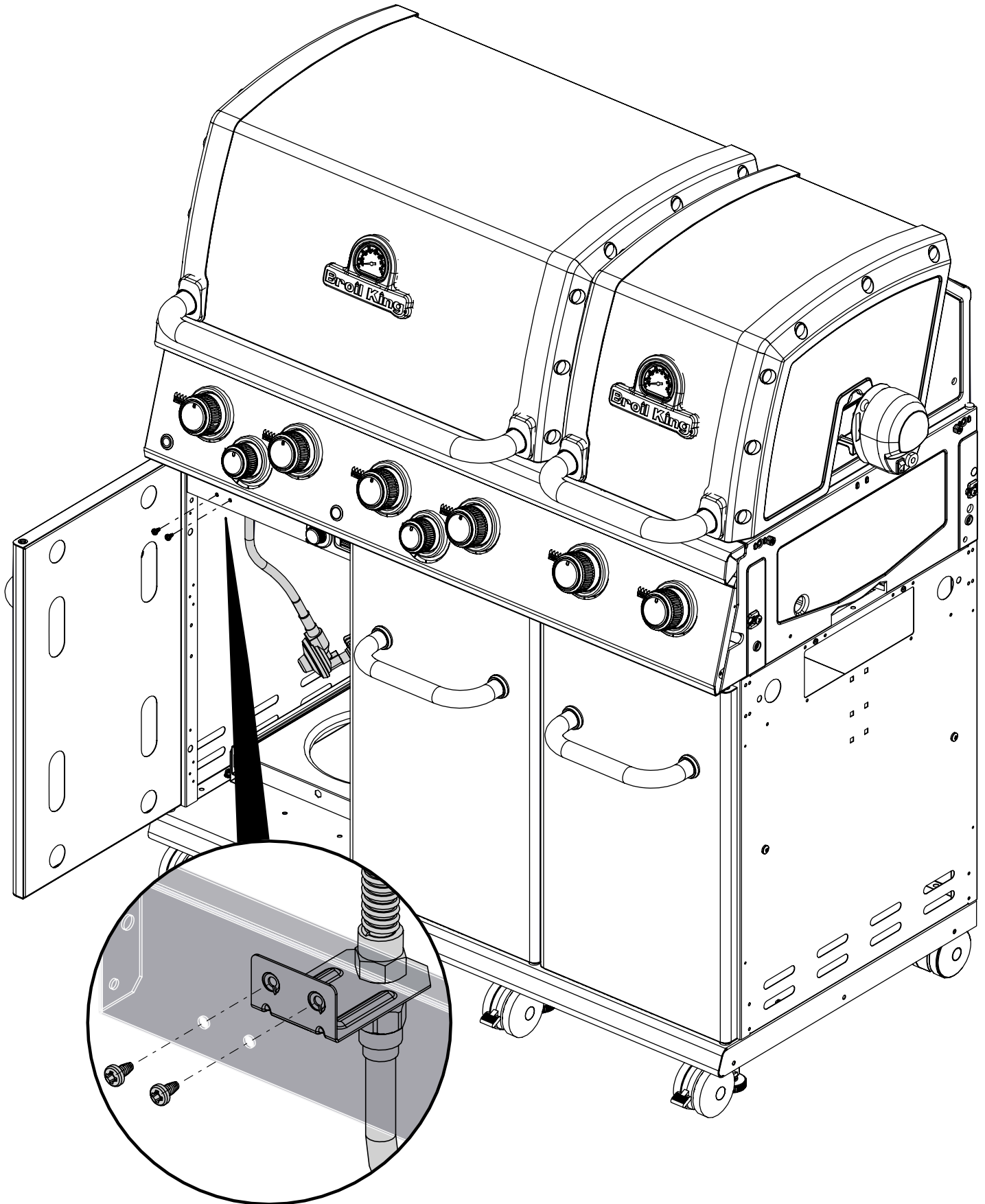

5

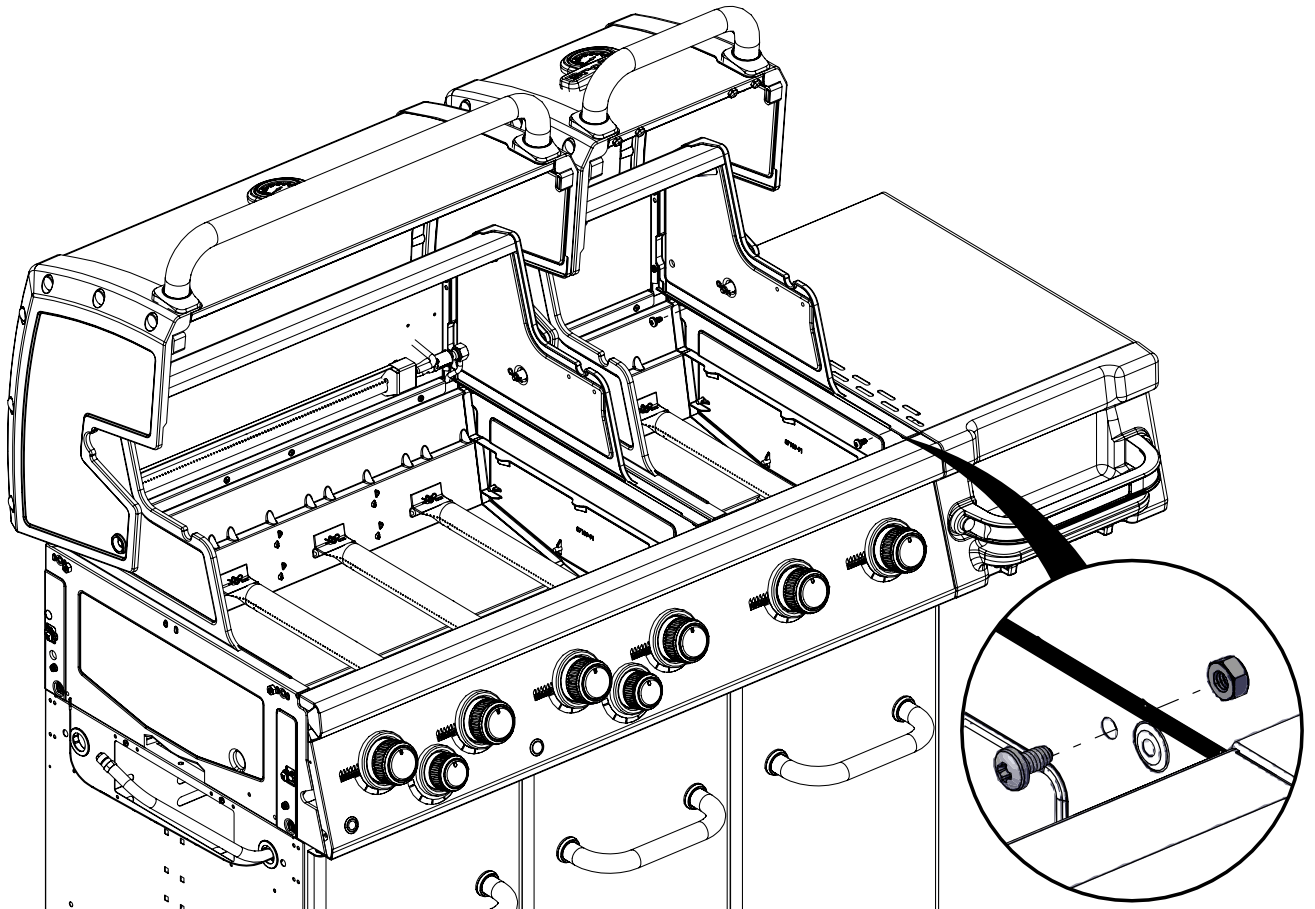
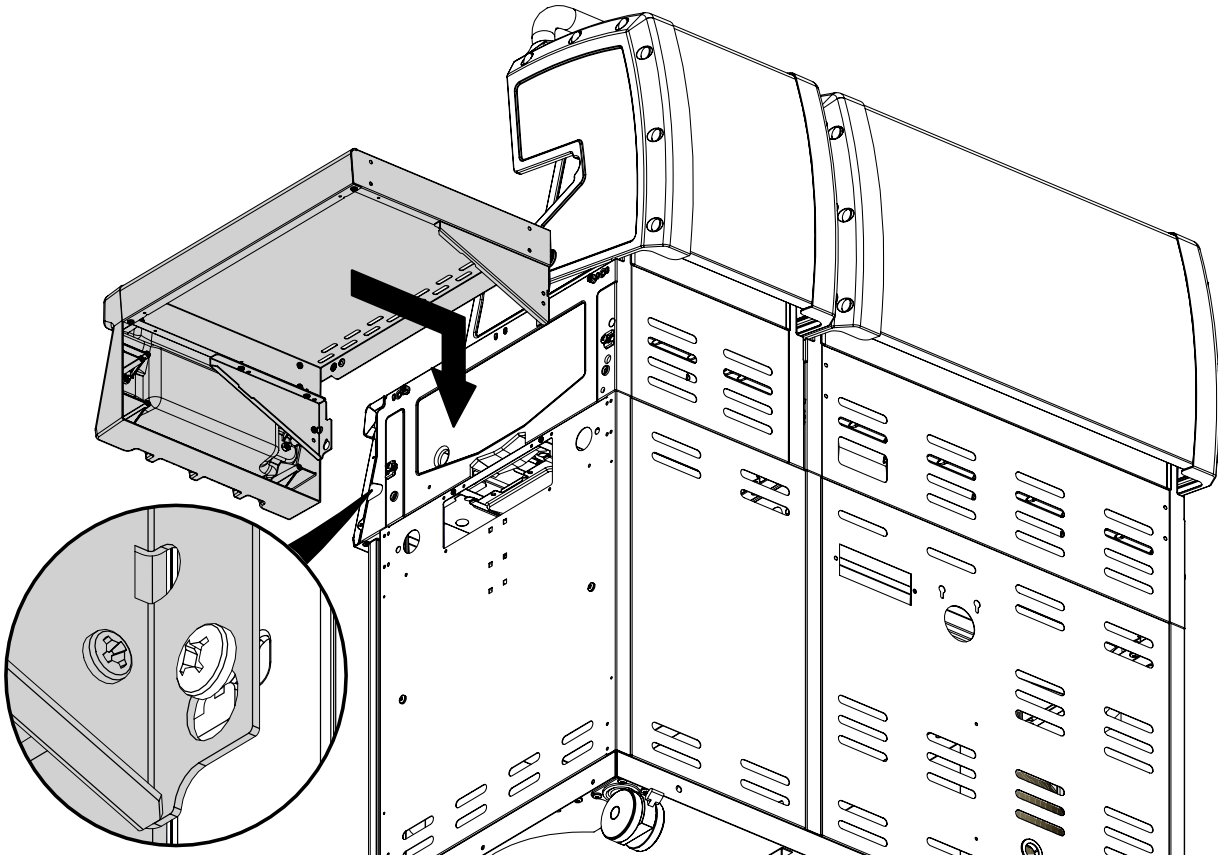
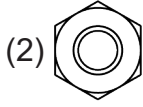
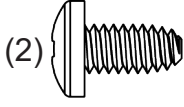

6

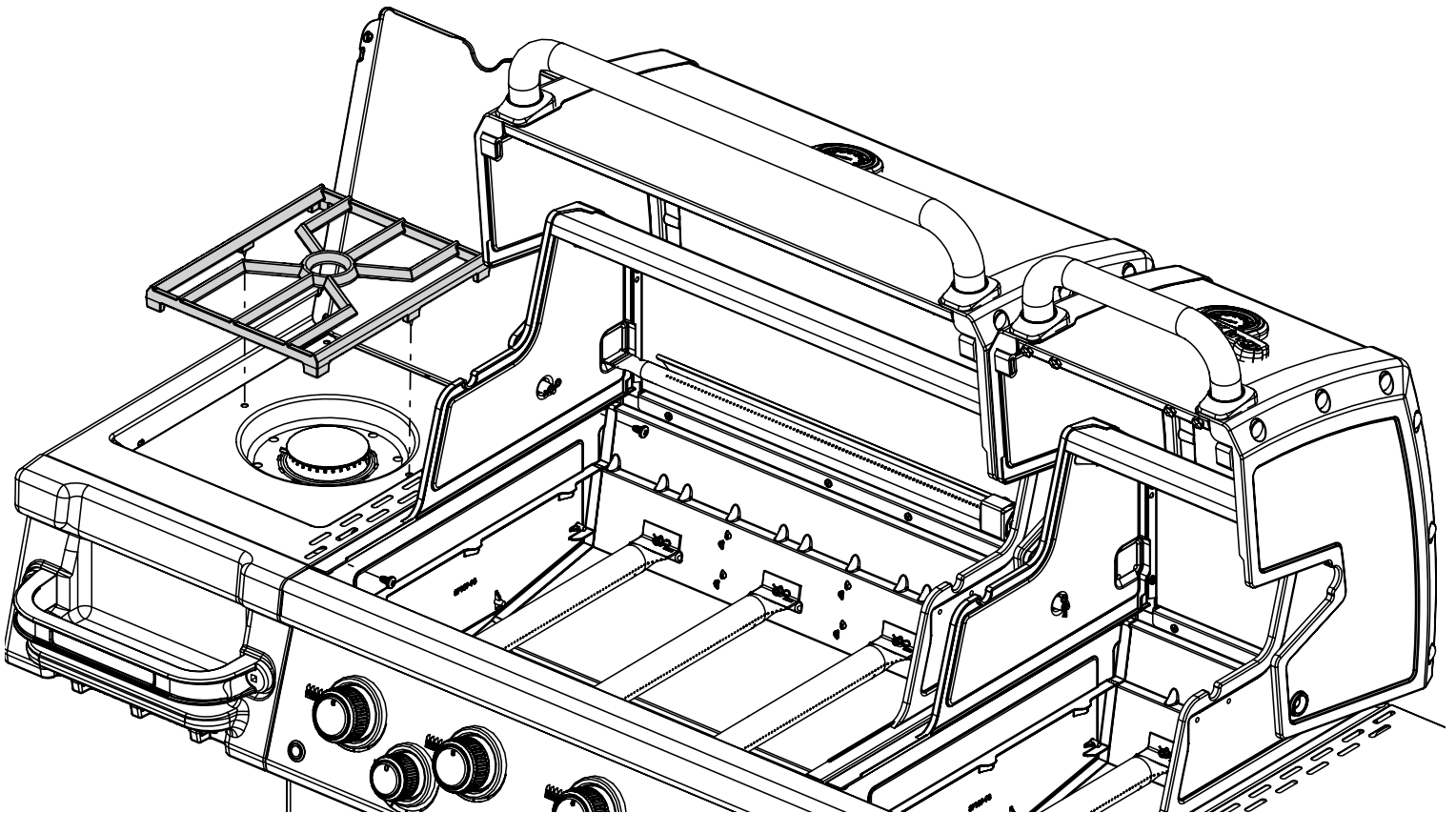
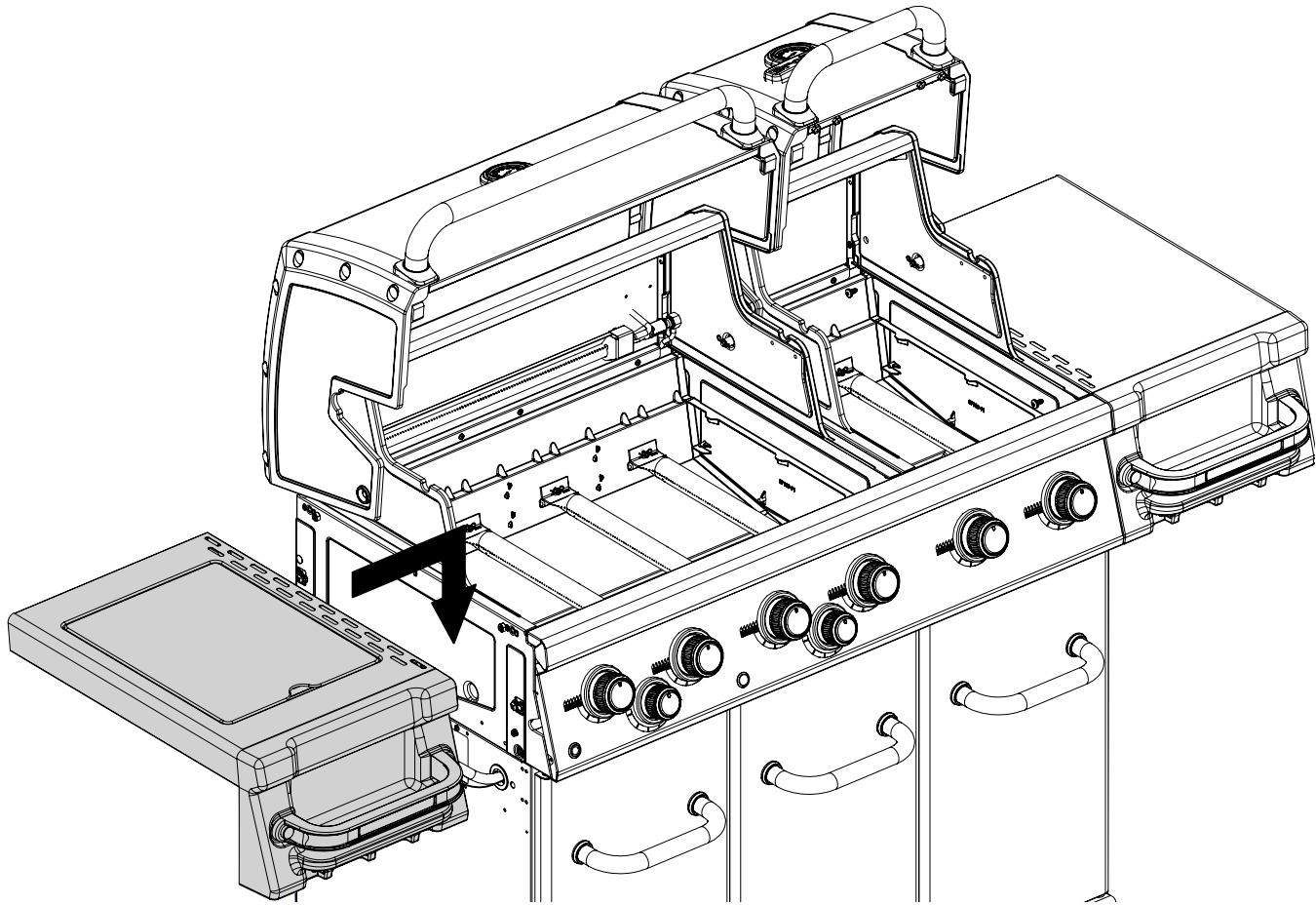
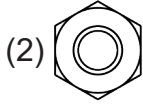
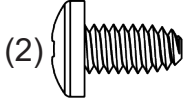

7

(1)

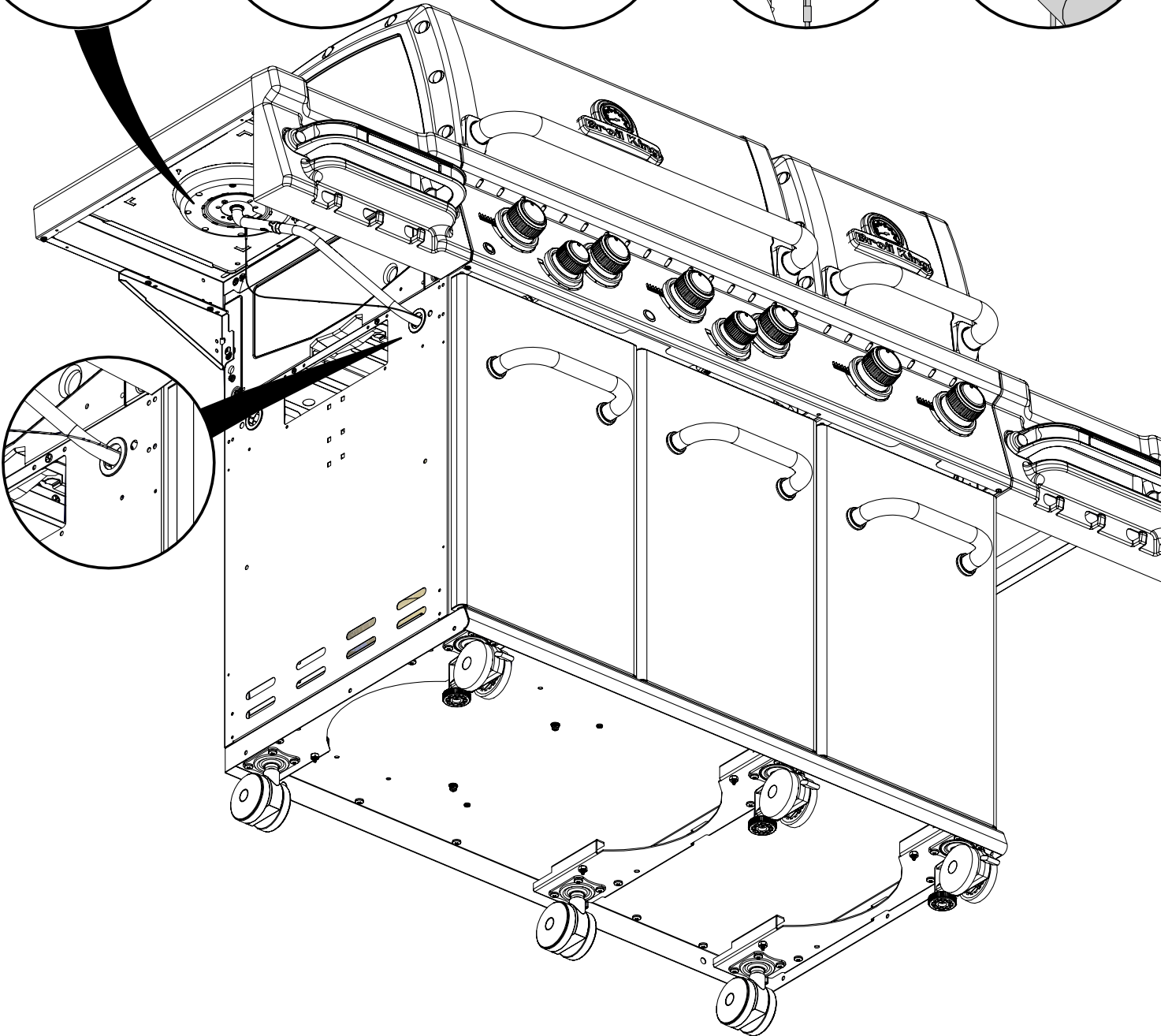
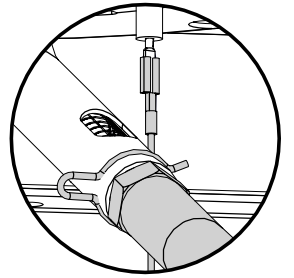
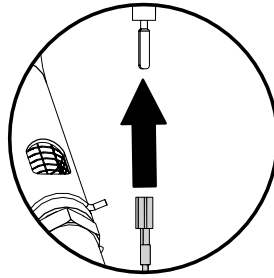
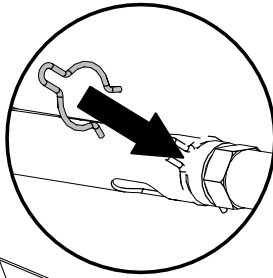
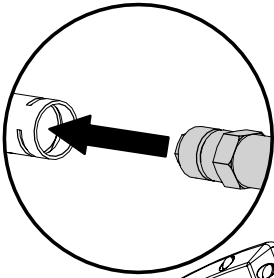
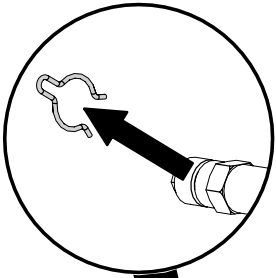
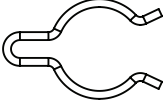

8

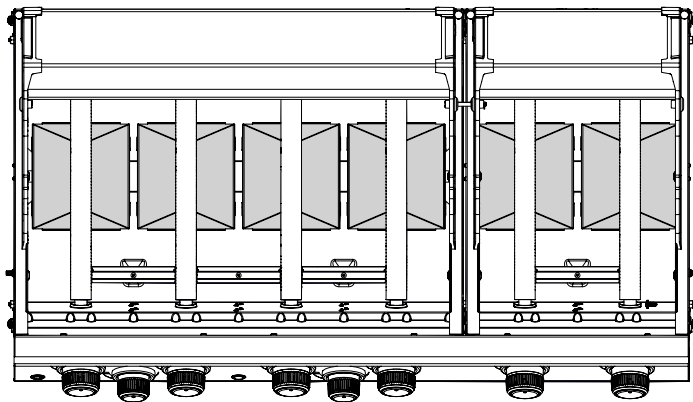
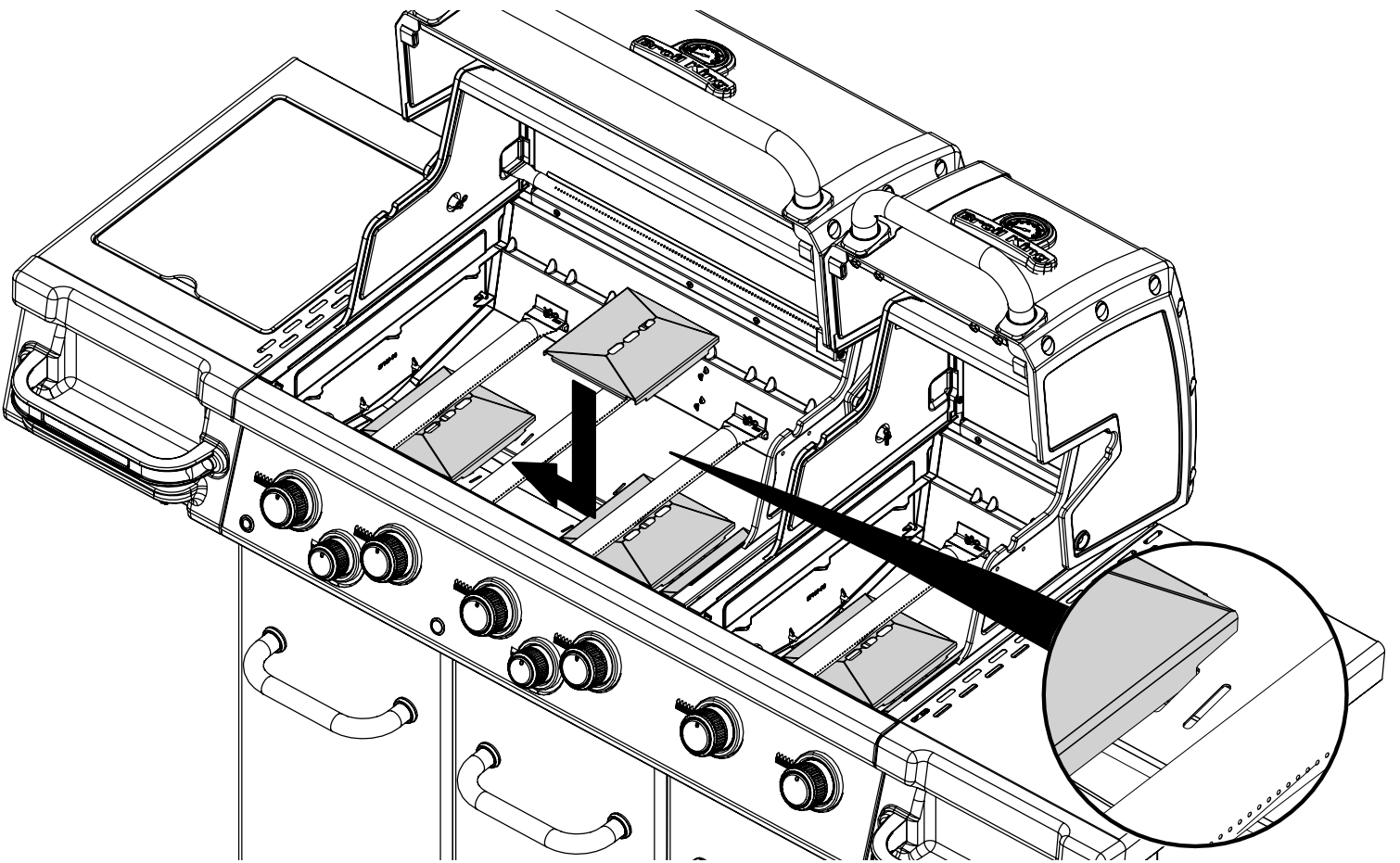
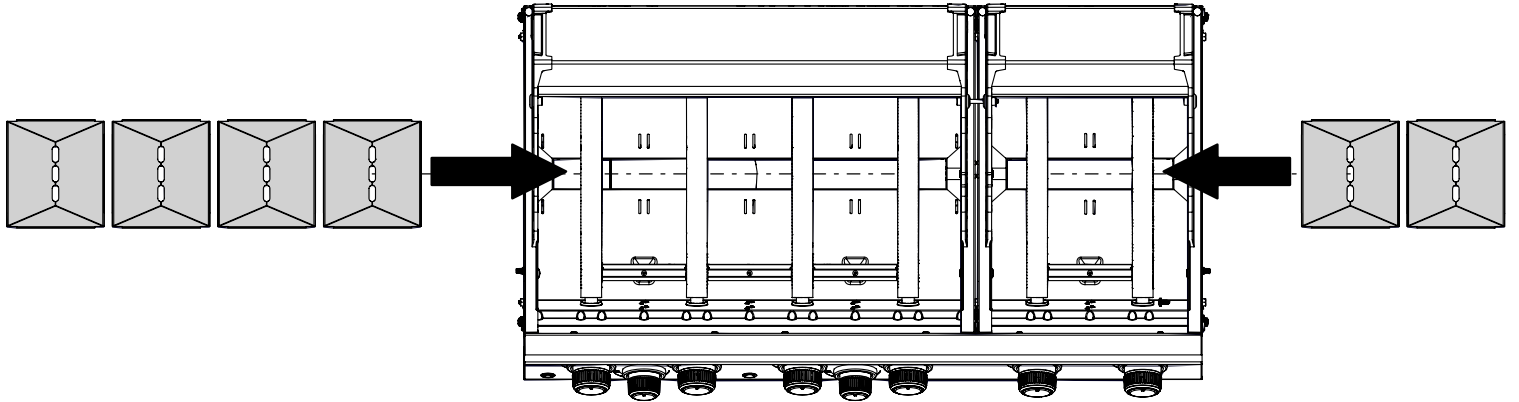

9

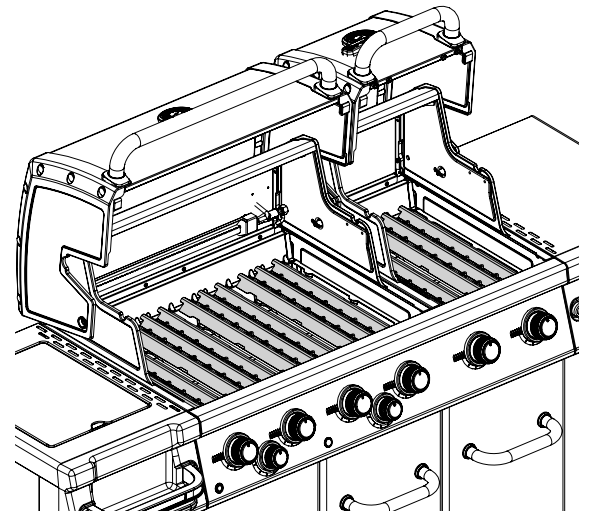
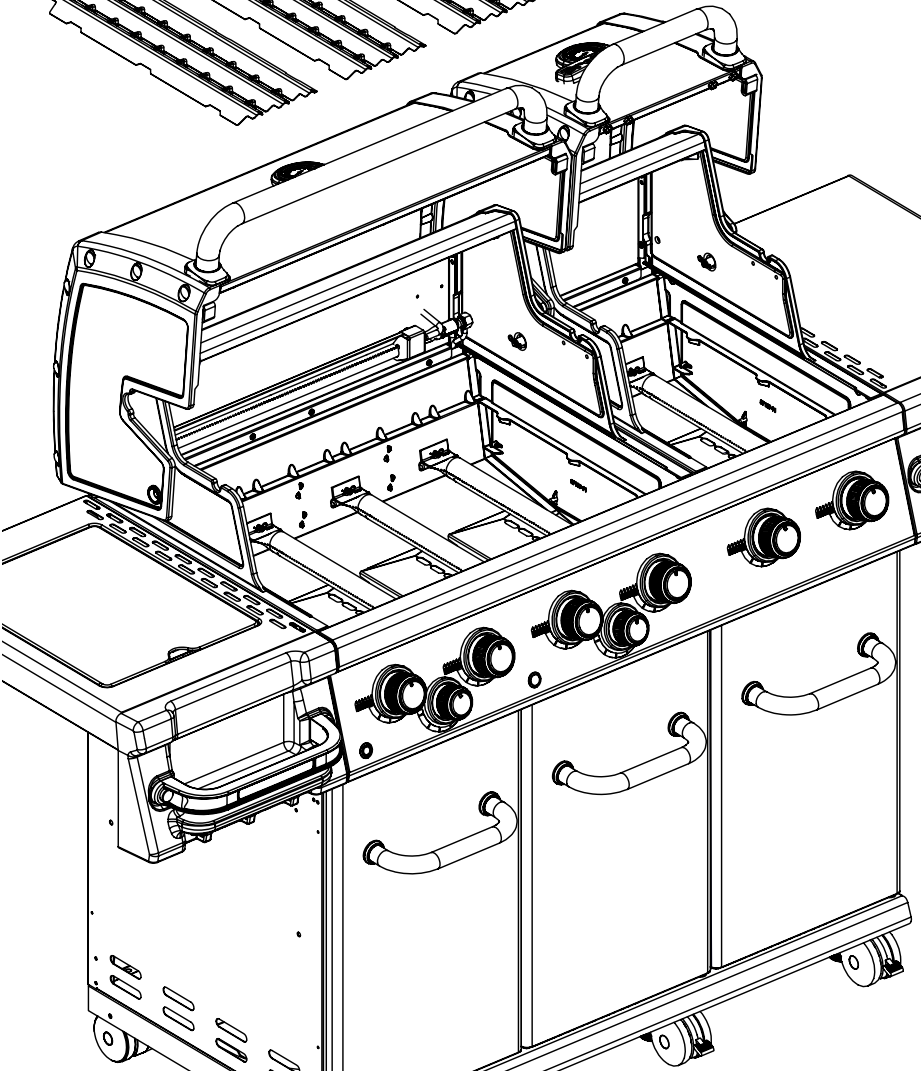
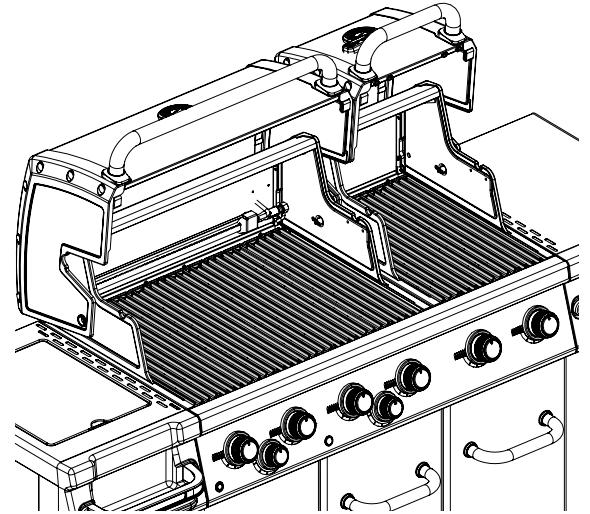
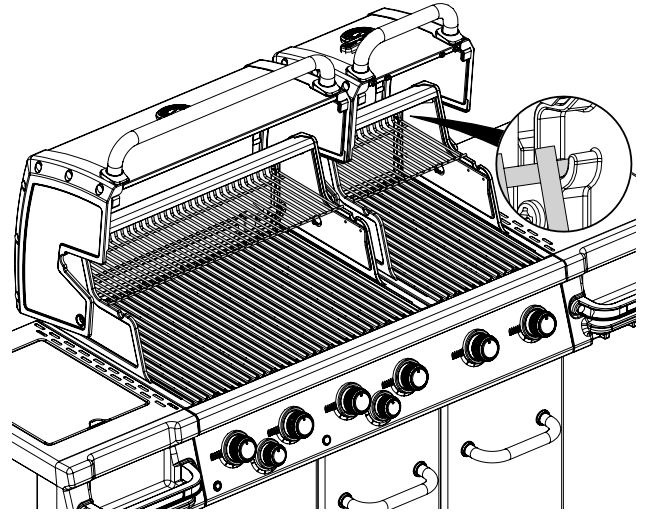
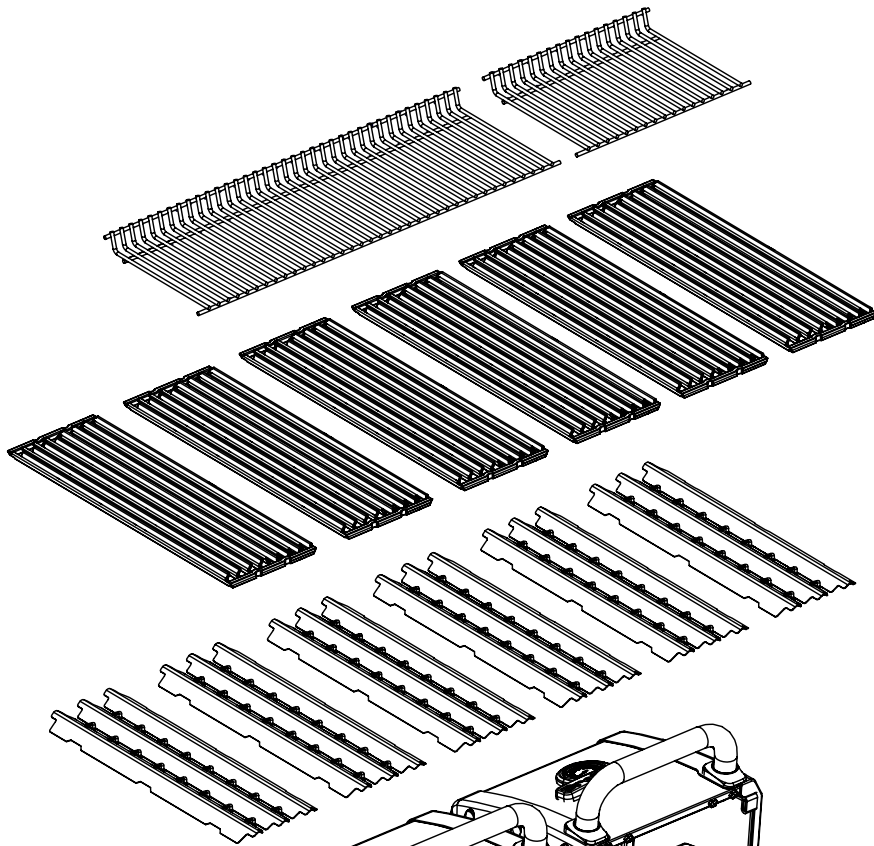

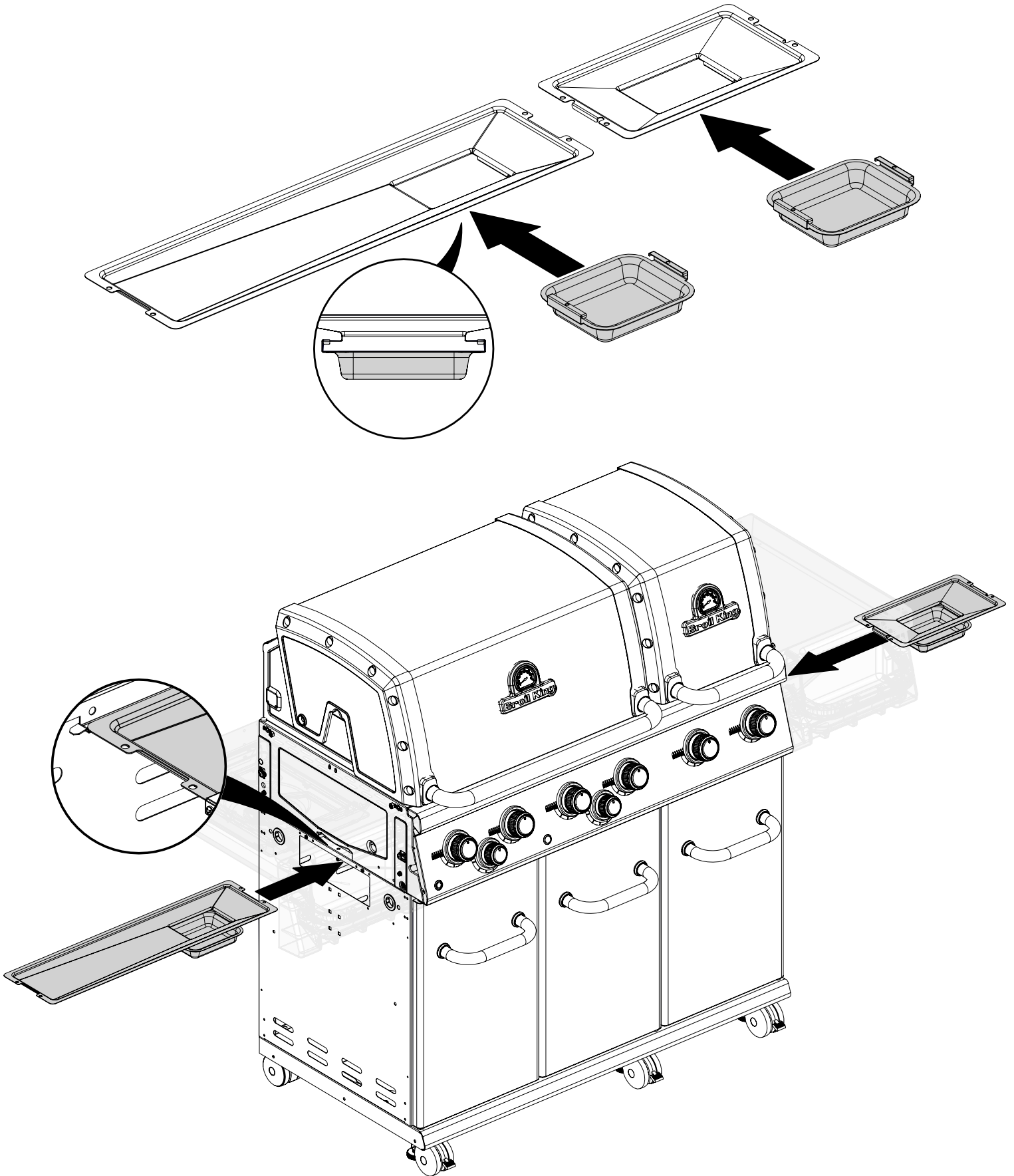

11

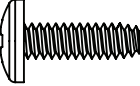
(2)  (2)

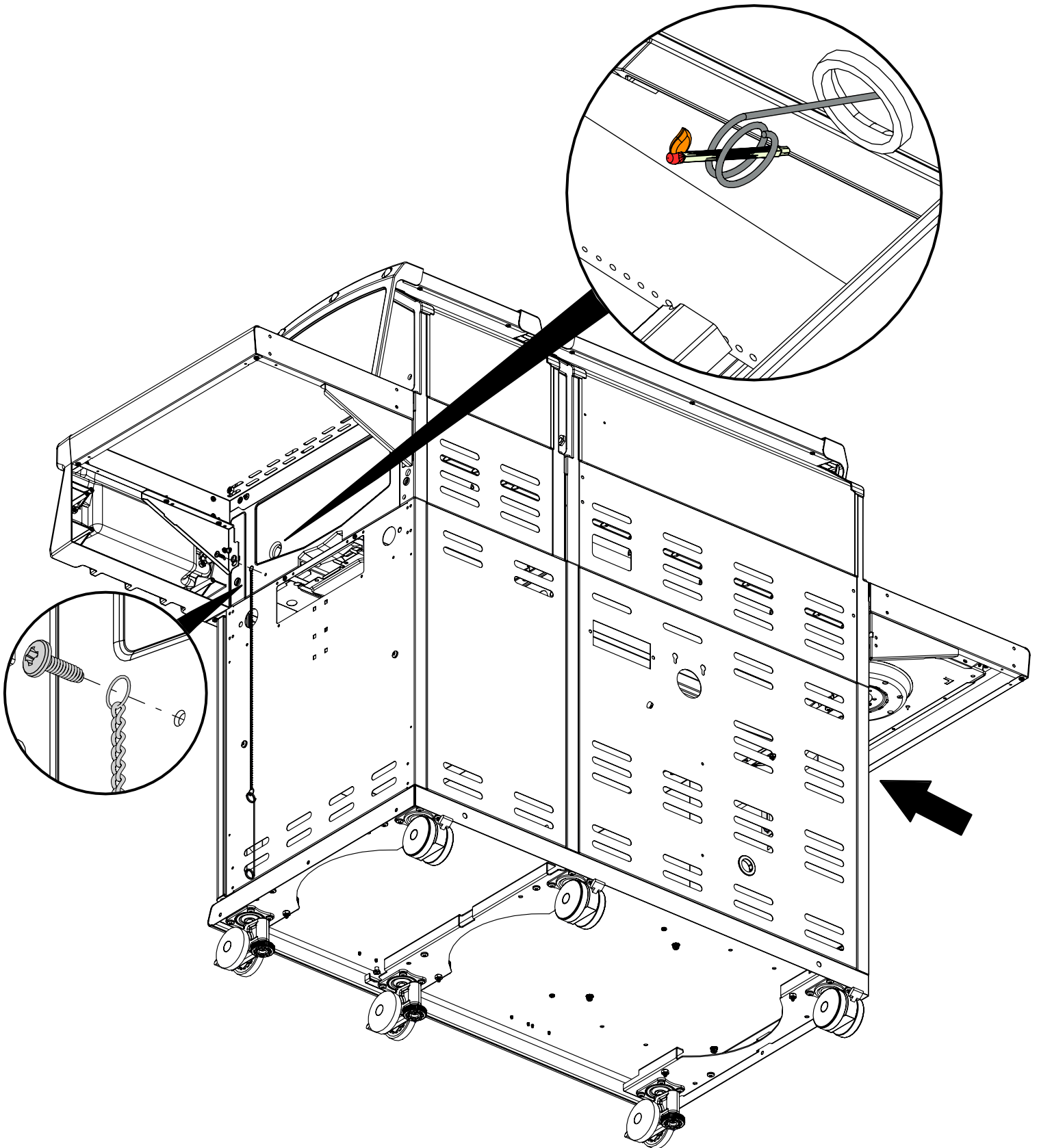

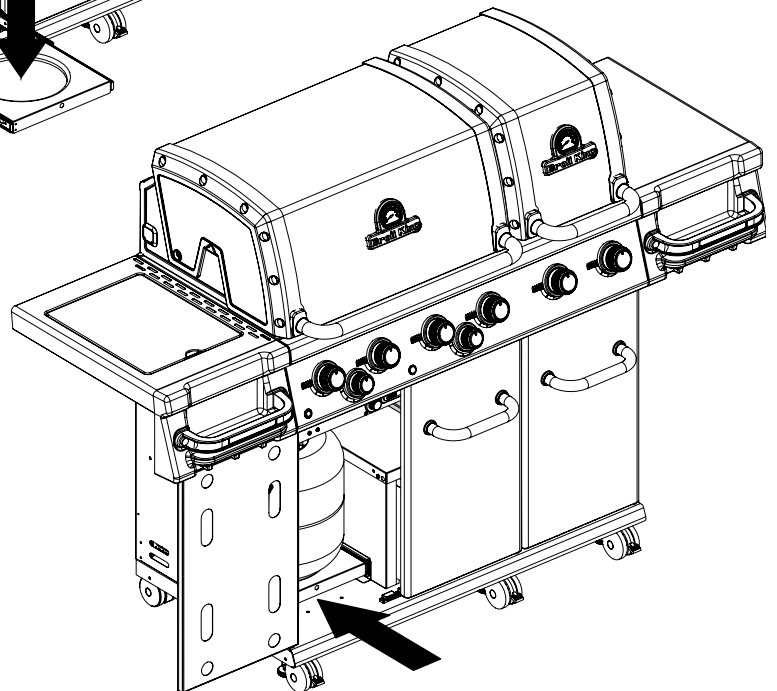
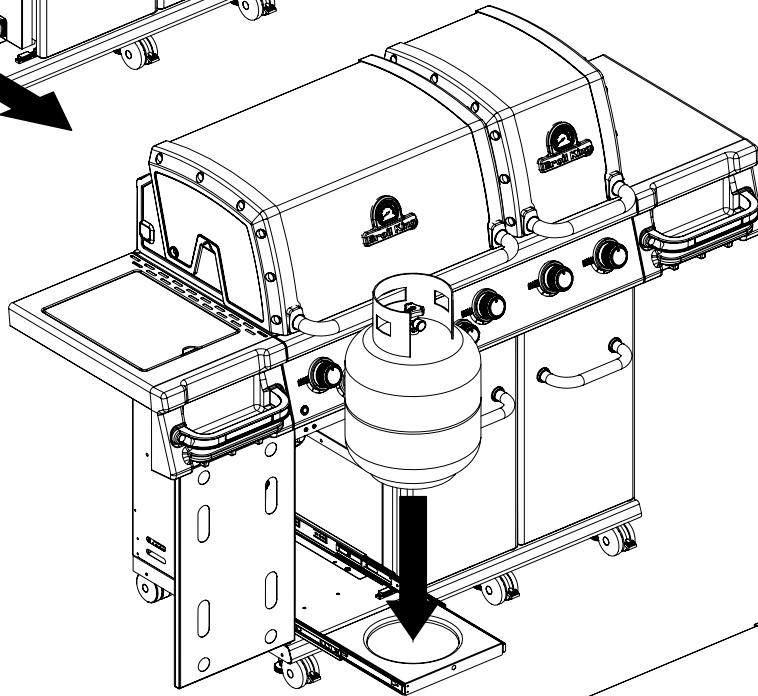
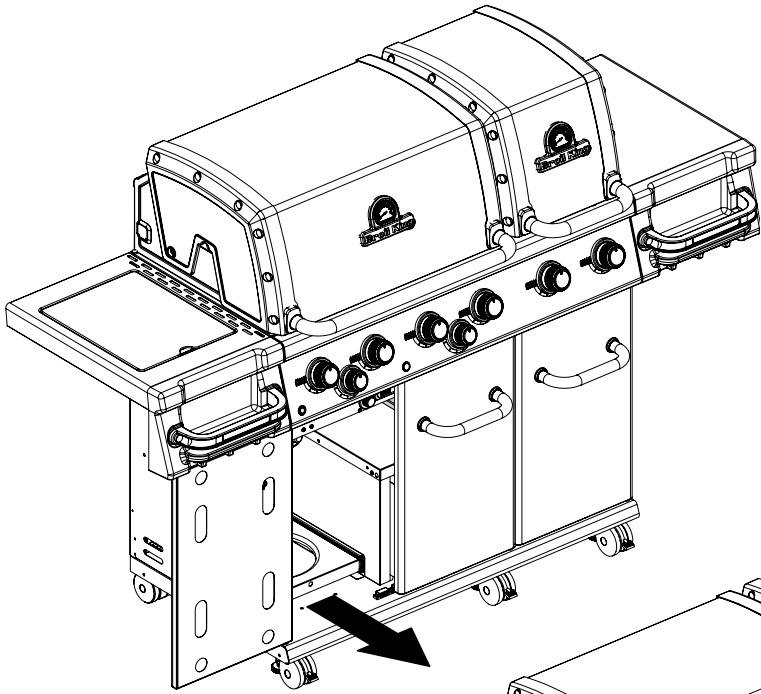

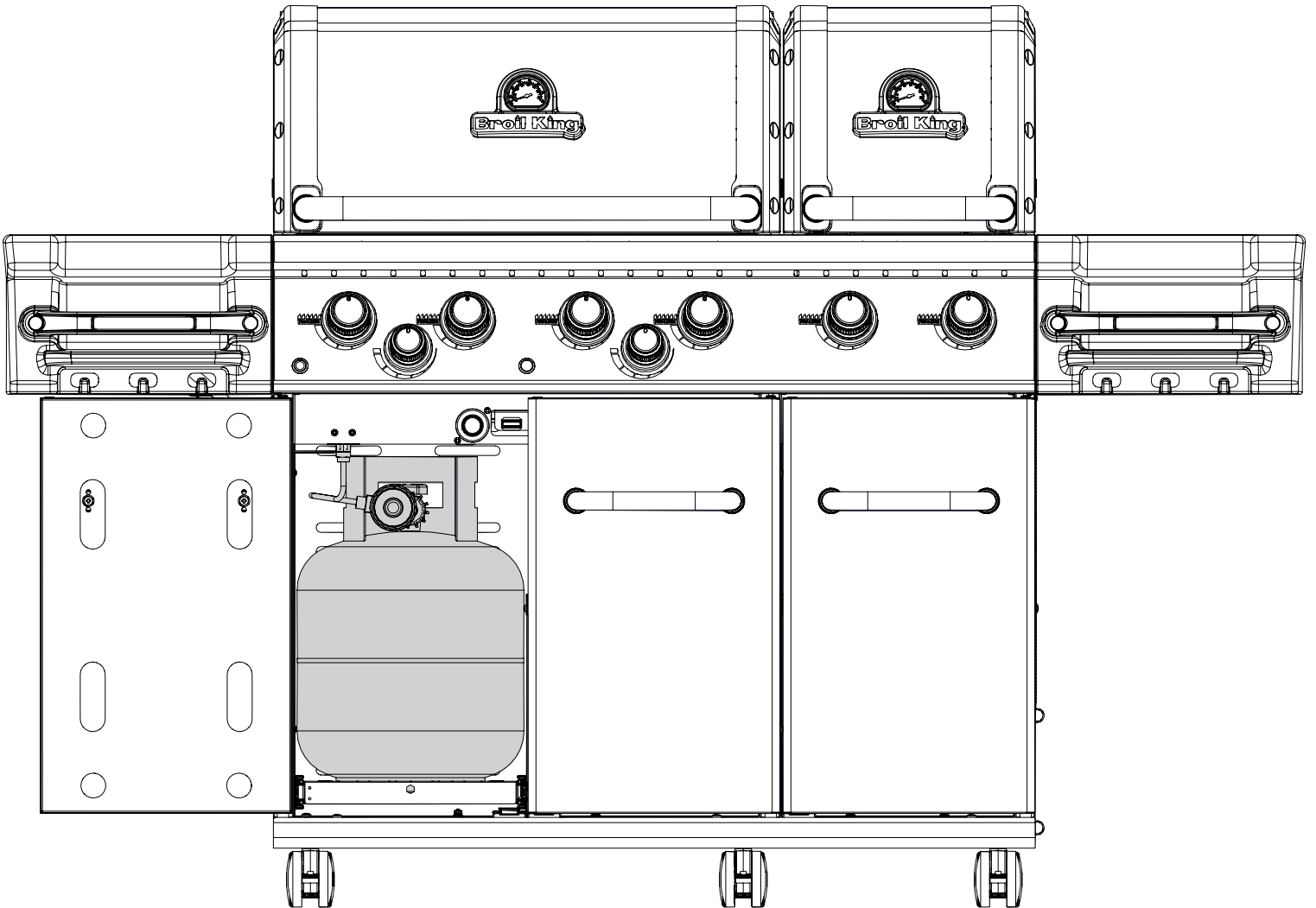
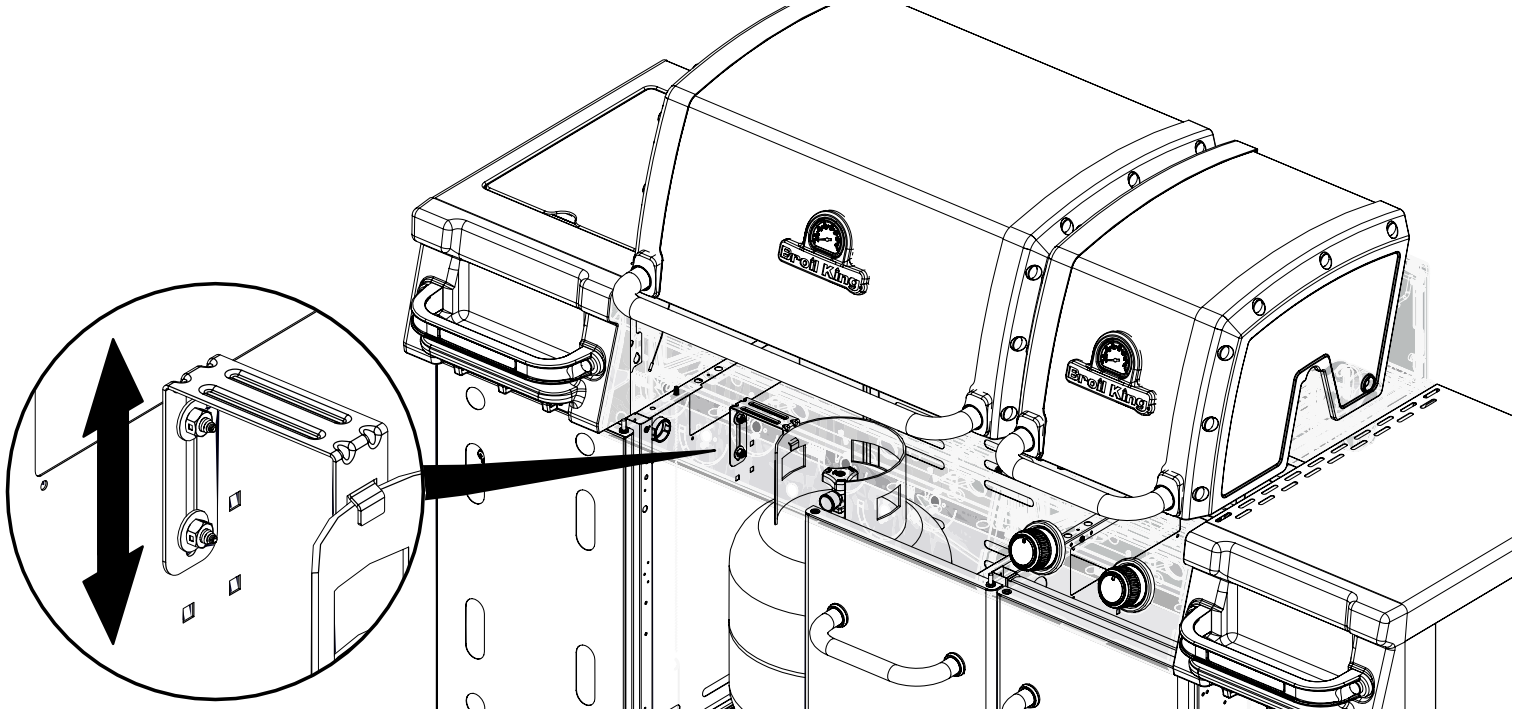

14

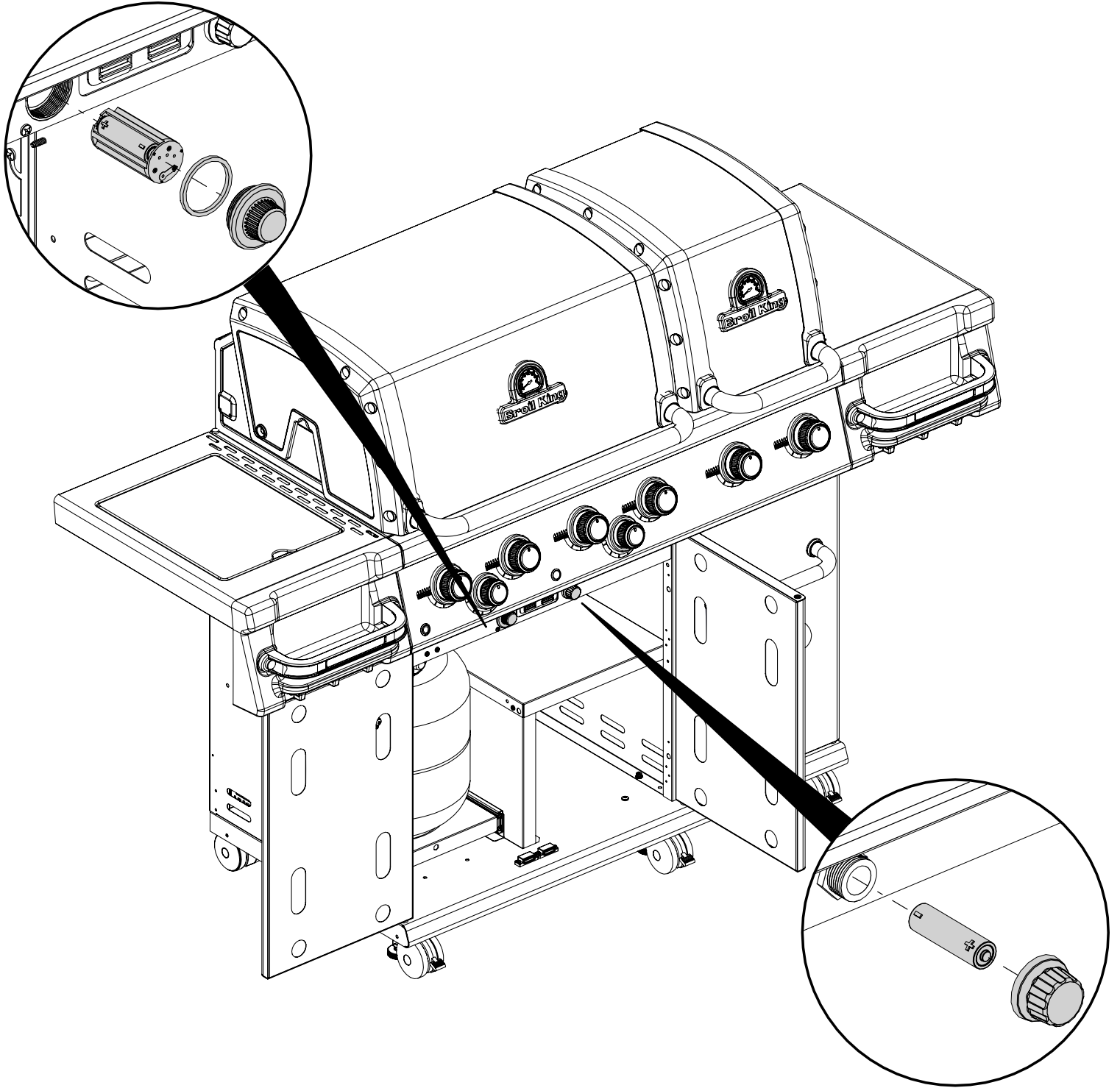
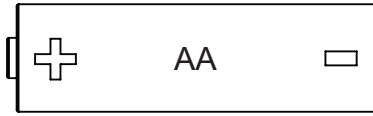

15

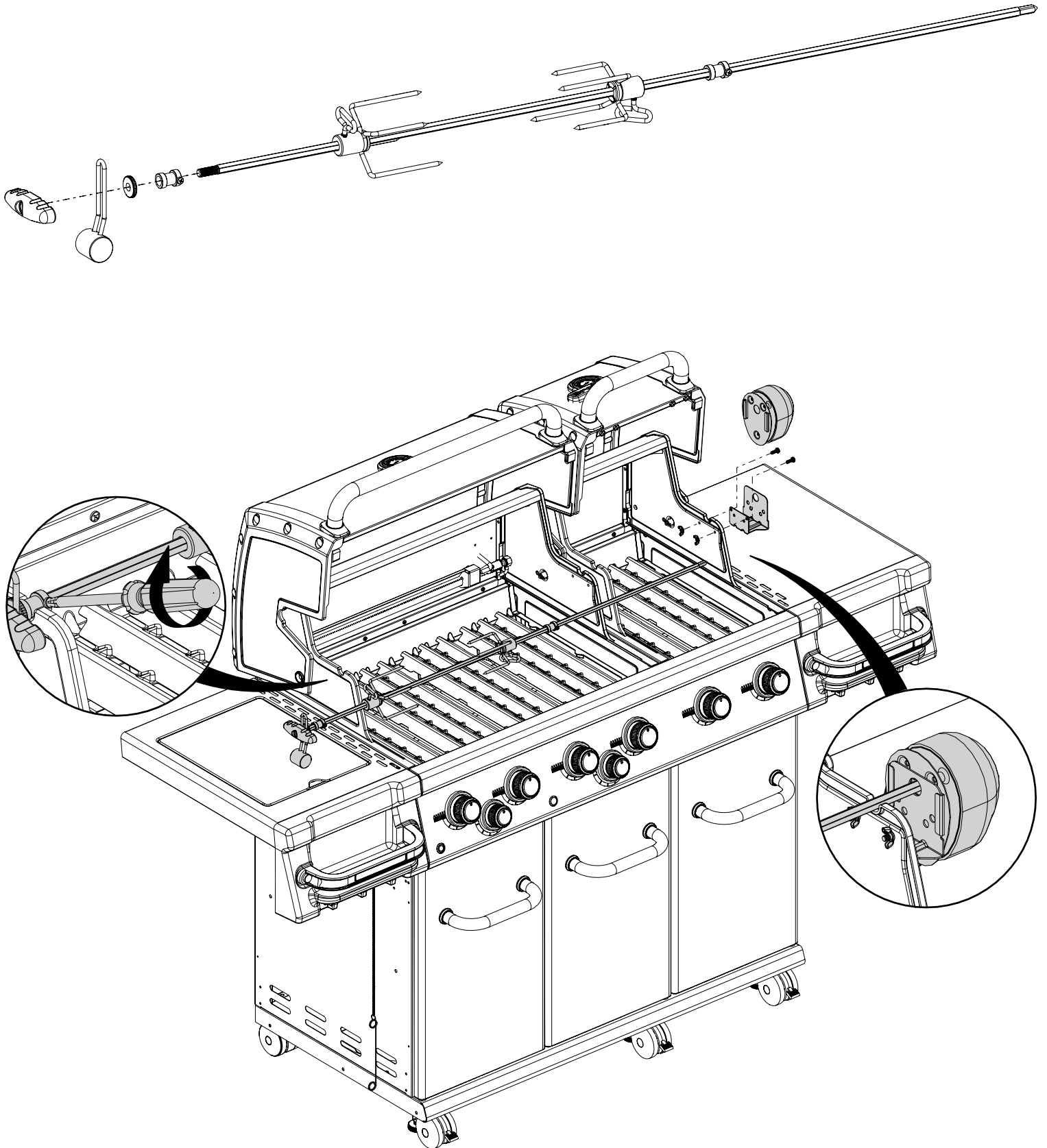

PARTS LIST / LISTE DES PIECES

<u>KEY #</u>	<u>ITEM #</u>	<u>DESCRIPTION</u>	<u>9972-83NZ</u>
1	27005-003	FIRE BOX ASSEMBLY	1
1A	27003-003	FIRE BOX ASSEMBLY	1
2	86005-301	LID ASSEMBLY	1
2A	86003-301	LID ASSEMBLY	1
5	27249-904	GREASE SHIELD	6
7	Y-11544	SCREW - BURNER	6
8	S21242	HITCH PIN CLIP	6
18	22005-281	COOKING GRID	6
20	22005-992	GRID - WARMING RACK	1
20A	22003-992	GRID - WARMING RACK	1
22	22025-904	COLLECTOR BOX	1
22A	22023-904	COLLECTOR BOX	1
25	22909-104E	BURNER	6
26	22001-769	CONTROL KNOB	6
26A	22001-669	CONTROL KNOB	2
27	22002-264	CONTROL BEZEL	6
27A	22001-164	CONTROL BEZEL	2
28	22008-883	CONTROL COVER	1
32	10111-16A	HOSE	1
34	S13473-091	HOSE-SIDE BURNER	1
34A	Y-11230	COTTER PIN	1
35	29018-074	CONTROL ASSEMBLY	1
36	10342-T21	ELECTRODE - SIDE BURNER	1
37	20809-957	TUBE-REAR BURNER ASSY	1
38	Y-11990	HEX NUT	1
40	10111-HR06	HOSE & REGULATOR	1
43	10342-E13	ELECTRODE	2
43A	10342-E22	ELECTRODE	1
44	10342-45	ELECTRONIC IGNITOR	1
44A	25070-92	WIRE - IGNITOR	1
44B	25070-93	BUTTON - IGNITOR	1
47	21035-991	GREASE RAIL	2
47A	21033-991	GREASE RAIL	2
48	22009-901	GREASE PAN	2
49	27055-901	GREASE TRAY	1
49A	27053-901	GREASE TRAY	1
51	22209-901	FLAV-R-WAVE ®	6
56	24005-12A	HANDLE	1
56A	24003-12A	HANDLE	1
58	54009-936	BEZEL	4
59	10081-BK630	NAMEPLATE	2
60	10571-6	HEAT INDICATOR	2
65	20005-000	MATCH LIGHT - STICK	2
68	23272-111A	DOOR	2
69	23272-131A	DOOR	1
70	21070-13	BEZEL	6
71	21071-13	HANDLE	3
78	21335-111	BRACKET - DOOR CATCH	1

PARTS LIST / LISTE DES PIECES

<u>KEY #</u>	<u>ITEM #</u>	<u>DESCRIPTION</u>	<u>9972-83NZ</u>
78A	21333-921	BRACKET - DOOR CATCH	1
80	21109-901R	SIDE PANEL	3
82	25208-201	SHELF - CABINET	2
83	21036-901	CABINET SHELF SUPPORT	1
85	21099-10A	BASE - TANK	1
88	21305-921R	PANEL - REAR	1
88A	25308-921R	PANEL - REAR	1
90	25098-951	BASE	1
100	21039-911	BRACKET - CASTOR SUPPORT	3
102	10892-23	CASTOR	3
102A	10892-285	CASTOR	3
103	21009-955	BRACKET - CYLINDER LP	1
114	23101-113	SHELF	1
115	23101-153	SHELF-SIDEBURNER	1
123	Y-12117	BUSHING	2
124	23000-271	SHELF-SIDE BURNER	1
125	23000-253	COVER-SIDE BURNER	1
126	10390-R81A	SIDE BURNER	1
128	23009-99	GRID	1
130	27905-354	BURNER ROTISSERIE	1
131	10693-109	REAR BURNER-ORIFICE	1
133	S15271	HANDLE	1
134	S15270	BALANCER	1
135	S15299	WASHER	1
136	S15263	BUSHING	2
137	S15260	SPIT ROD	1
138	S15287	4 PRONG FORKS	2
139	57039-901	ROTISSERIE BRACKET	1
140	S21125	SCREW #8 X 1/2	6
141	Y-11559	SCREW - 1/4-20 X1	4
144	Y-12220	BUSHING	1
145	S21235	HINGE PIN	2
145A	10240-17	HINGE PIN	1
146	S21233	HITCH PIN CLIP	3
147	Y-11231	LID BUMPER	4
148	10240-20	DOOR PIN	3
149	Y-11551	DOOR PIN	3
150	Y-12124	DOOR PIN CAP	3
152	Y-12222	MAGNET	3
153	Y-12223	SNAP IN MAGNET	3
154	Y-11560	SCREW 1/4-20 X 1-1/2	12
155	S21124	SCREW #8 X 1/2	26
156	Y-11793	NUT 1/4-20	10
157	Y-12835	SCREW #6-32 X 1/4	2
158	Y-12646	SCREW - SHOULDER #8 X 1/2	2
159	S21127S	SCREW #8 X 3/8	16
160	Y-29304	SCREW #10-24 X 3/8	6
161	Y-12310	SCREW #1/4-20 X 3/4	10

PARTS LIST / LISTE DES PIECES

<u>KEY #</u>	<u>ITEM #</u>	<u>DESCRIPTION</u>	<u>9972-83NZ</u>
162	S35095	SCREW #10-24 X 5/9	2
163	S35094	SCREW #10-24 X 5/8	2
169	S21061	WING NUT	2
171	S15247	MOTOR	1
172	S15508	ELECTRODE	1
173	S21362	SPRING	1
174	Y-12871	SCREW M4 X 0.7	2
175	Y-11546	SCREW - SHOULDER 1/4-20 X 5/8	2
176	S21255	WASHER	2
178	Y-11795	NUT 1/4-20	2
180	Y-12857	WASHER	6
181	25030-73	WIRE - TRANSFORMER	1
181A	25070-95	LIGHT SWITCH	1
184	25080-80	BATTERY PACK	1
186	Y-12865	SCREW 1/4-20 X 3/4	47
190	25020-84	WIRE - LED LIGHT	1
191	25020-84	WIRE - LED LIGHT	1
193	SP11-25	LID BUMPER	4

